

Gascoyne Food Bowl Initiative Borefield Initial Development under agreement with Department of Primary Industries & Regional Developments

DETAILS

Table 1 - Bore Details

Bore ID#/Description	Distance Marker	Northing	Easting	Spur Length (m)	Spur DN
B78/15 production bore	16km	7255364.123	797354.257	348.9	225
B22/15 paired monitoring bore	16km	7255375.115	797357.658	NA	NA
B59/14 production bore	18km	7256576.736	799795.614	44.0	225
B51/14 paired monitoring bore	18km	7256566.648	799794.789	NA	NA
B52/14 production bore	24km	7259667.074	198029.375	21.3	225
B31/14 paired monitoring bore	24km	7259674.928	198027.372	NA	NA
B66/14 production bore	22km	7258863.403	803280.627	66.4	225
B18/14 paired monitoring bore	22km	7258858.744	803271.473	NA	NA

At the production bore location we will be installing the following equipment:

- pump & riser main;
- headworks;
- scada tower and control equipment;

The collector main, bores and power infrastructure is already installed under the Gascoyne Food Bowl Initiative Project.

798000

800000

802000

804000

806000

7260000

7260000

7258000

7258000

7256000

7256000

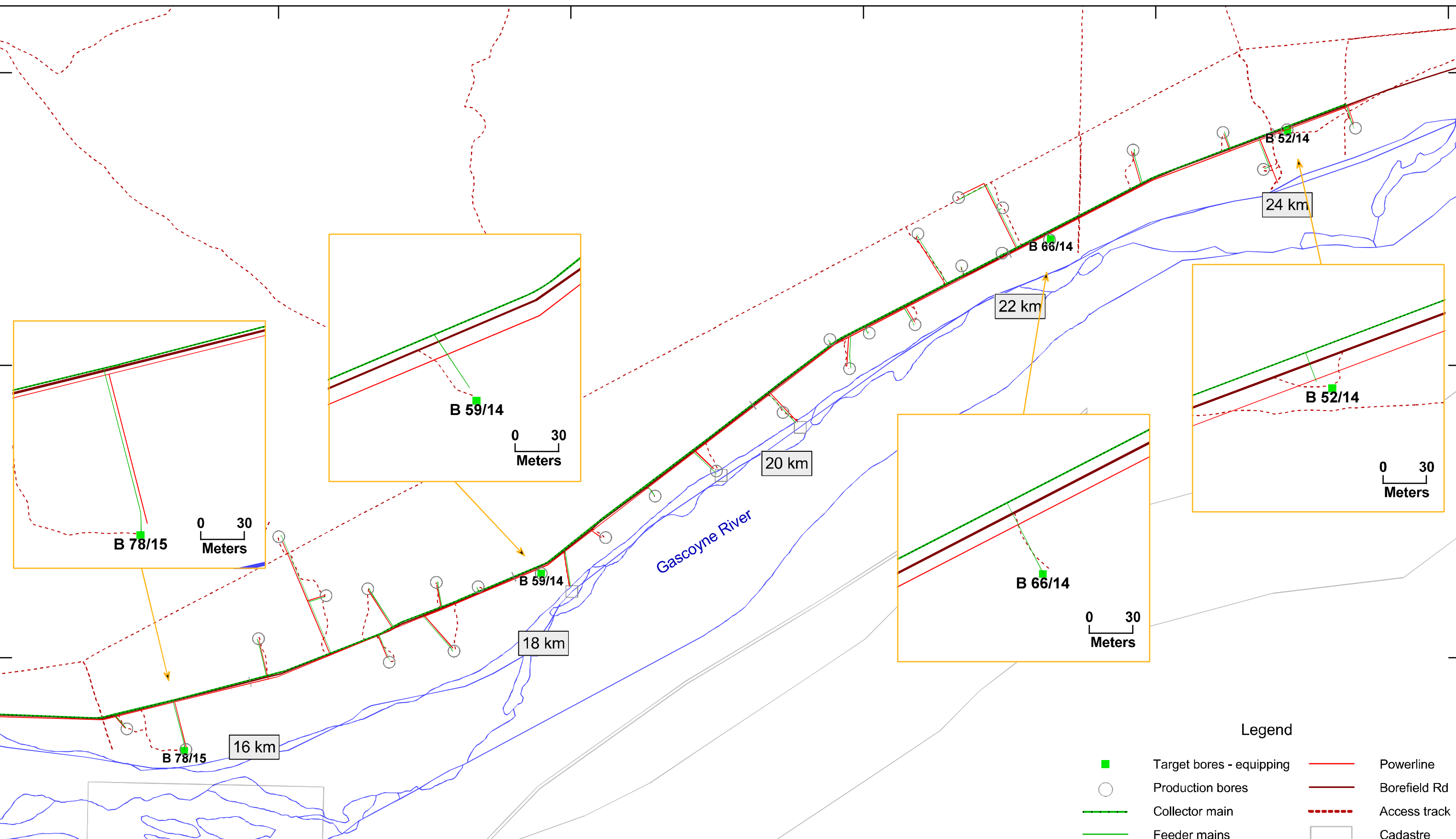

Legend

- Target bores - equipping
- Production bores
- Collector main
- Feeder mains
- Powerline
- Borefield Rd
- - - Access track
- Cadastre

Created By: GIS group, Agriculture and Food
 Projection: Universal Transverse Mercator
 Datum: Geocentric Datum of Australia 1994
 Grid: Map Grid of Australia 1994 Zone 49

Date: 8th September 2017
 Job Number: 2017059

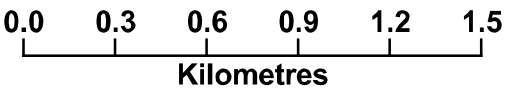
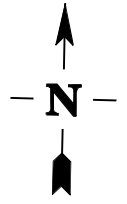

GASCOYNE FOOD BOWL INITIATIVE STAGE 2 BOREFIELD EARLY ACCESS TO BORES PROJECT within the Carnarvon Water Reserve

EQUIPPING OF FOUR(4) PRODUCTION BORES NOTICE OF PROPOSAL – GENERAL WORKS

DISCLAIMER: While all reasonable care has been taken in the preparation of the material in this document, the Western Australian Government and its officers accept no responsibility for any errors or omissions it may contain, whether caused by negligence, or otherwise, or for any loss, however caused, sustained by any person who relies on it